

# 戶外型LED數位看板產品型錄

High density display for best indoor viewing even under high ambient lighting

# 1 SHOW DETAILS

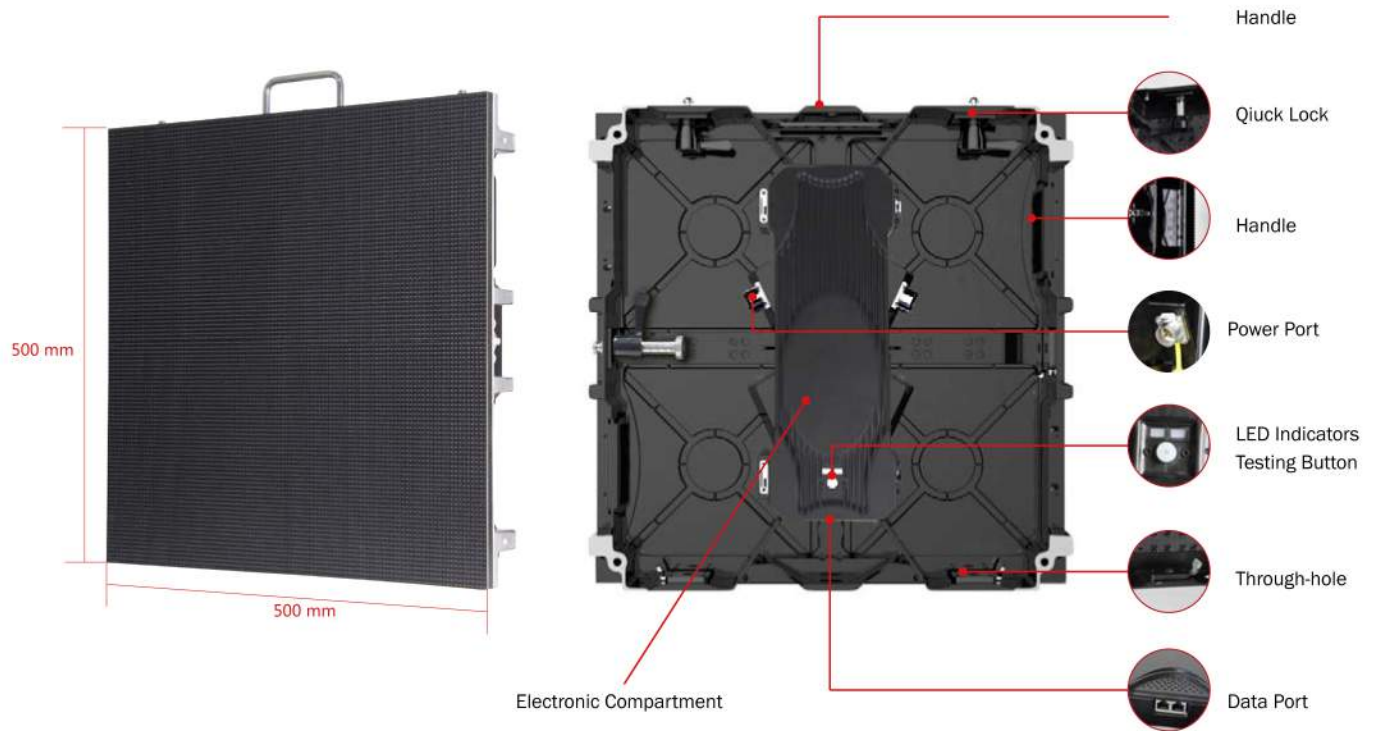

# 2 PRODUCT INTRODUCTION

Excellent design should be easy to understand, the product will talk for itself, cancelling the necessity of detailed explain.

Seamless stitching: With our special connector design it is easy to reduce gaps while installing, creating a perfect display.

Adopt the latest anti-collision technology, make a more stable cabinet during rental events, make a longer life span.

Die cast aluminum control box, adapt to all kinds of weather.

Customized Arc design: bevel edge cabinet design according to customer requirements makes Arc screen assembling.

Gapless connection: under 0.1 mm tolerance gap between cabinet and module, under 0.2 mm tolerance gap between cabinets.

### 3 PARAMETER DISPLAY

Parameters	Value		
Pixel pitch(mm)	4.8	5.9	6.9
Pixel configuration	SMD2525 3-in-1	SMD3535 3-in-1	SMD3535 3-in-1
Pixel Per Module(Pixels/m <sup>2</sup> )	52x52	42x42	36x36x
Module size(mm)	250x250	250x250	250x250
Brightness(cd/m <sup>2</sup> )	≥4500	≥4800	≥4500
Viewing angle(H/V)	H:110/V:100	H:110/V:100	H:110/V:100
Cabinet size(mm x mm)	500x500x65	500x500x65	500x500x65
Cabinet weight(kg)	≈7.5kg	≈7.5kg	≈7.5kg
Display Refresh rate(Hz)	≥1,920	≥1,920	≥1,920
Input Power Frequency(Hz)	50/60	50/60	50/60
Input voltage(Nominal)(V)	AC110, 220, 110-220	AC110, 220, 110-220	AC110, 220, 110-220
Input Power (Max)(W/m <sup>2</sup> )	≈720	≈720	≈600
Input Power (Average)(W/m <sup>2</sup> )	≈360	≈360	≈300
Lifespan(H)	≥50,000	≥50,000	≥50,000

### 4 NETWORK MULTIMEDIA SYSTEM CONNECTIONS

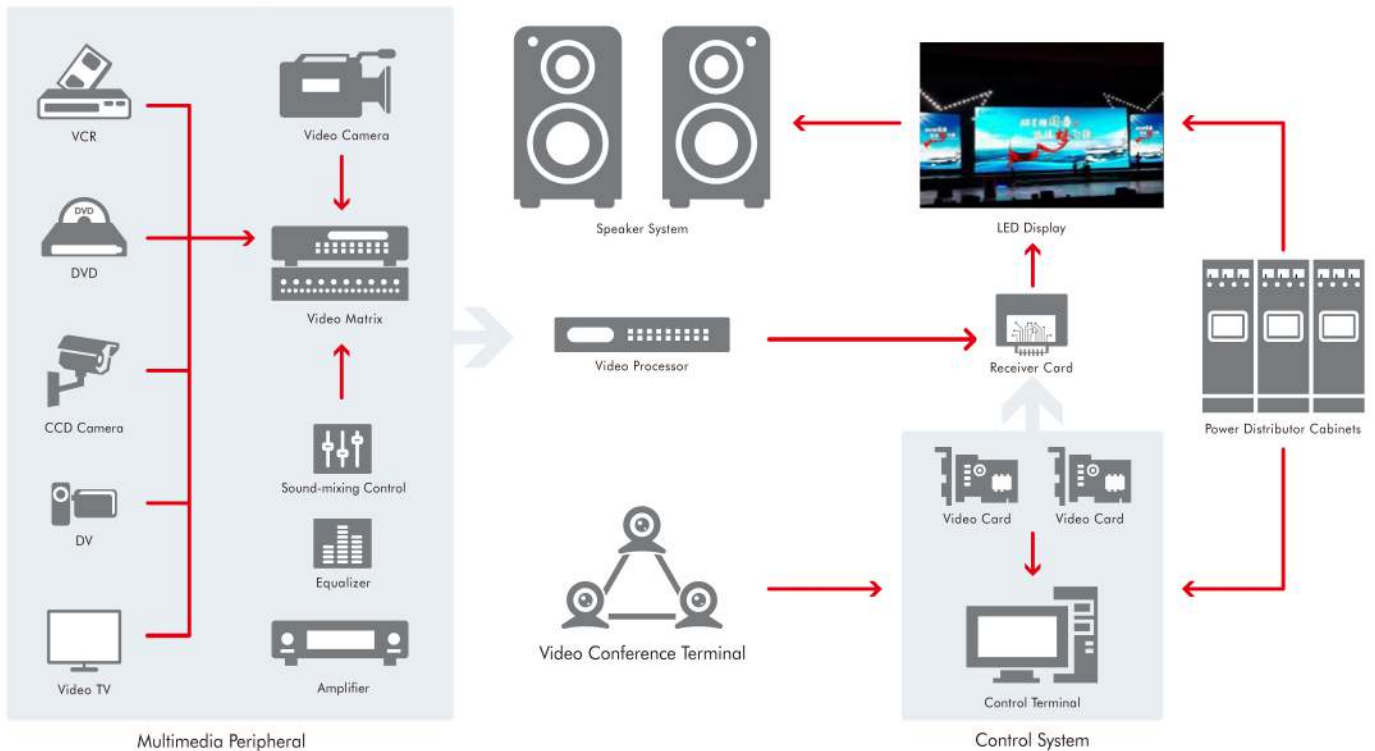

**5** CABINET INSTALLATION DIAGRAM

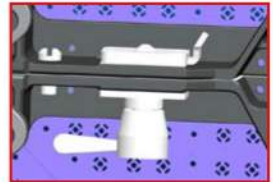
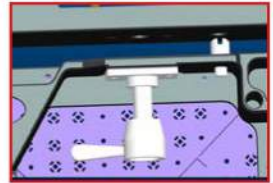
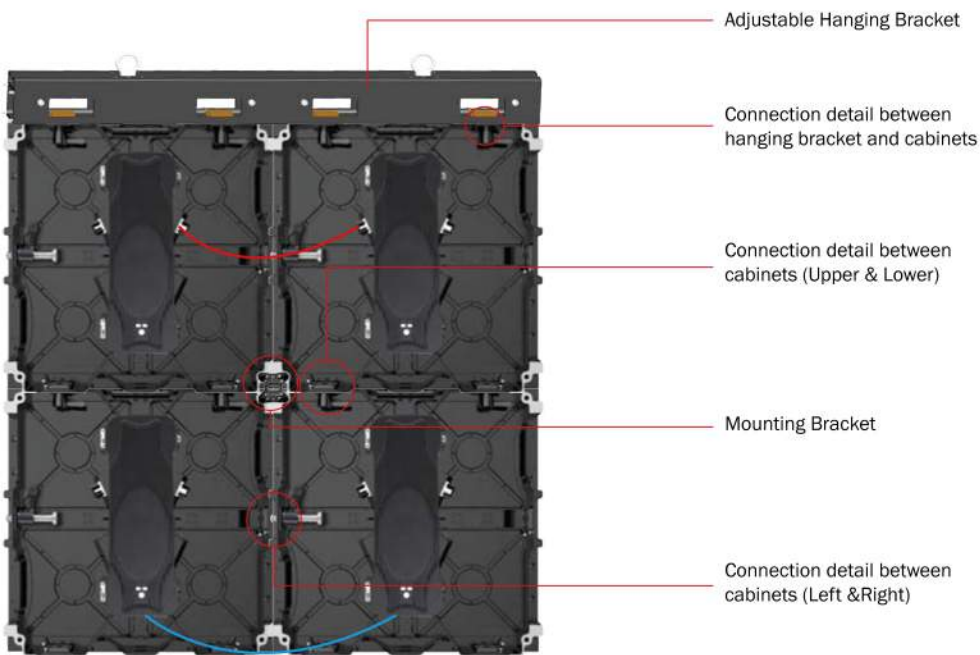

— Data Interconnect Cable      — Power Interconnect Cable

**6** STANDARD ACCESSORIES



Main Power cable



Power cable



Receiving Card



Connector



Main signal cable



Signal cable



Hanging Beam